



Marbella *Pencil Edge*

Marbella features a remarkable 3/16" radius for a surface that makes a dramatic statement. Refined and modern, this edge is the perfect option for bringing sophisticated style to every space. Combining natural beauty with the signature durability and low maintenance of laminate, VT Dimensions stretches remodeling budgets further.

Marbella Pencil Edge

Expect More from VT Dimensions

Bring together modern style, intriguing depth, and the seamless edge you want with the beautifully contoured look of VT Dimensions countertops.

Beyond the beauty, you'll have the assurance of knowing VT fabricates the whole countertop from top to bottom—not just the laminate surface—for consistent quality and service. And you get a 1-year warranty you can count on.

One source. Many beautiful looks. Only from VT.



Edge: Marbella
Laminate: Old Mill Oak
Wilsonart® 7973-12

Specifications

- Standard substrate is $\frac{3}{4}$ " industrial-grade particleboard, available in 8', 10', and 12' lengths
- Standard postformed-grade laminate with a thickness of $0.042" + 0.002" - 0.008"$
- Both standard and special styles and sizes are suitable for all residential, commercial, institutional, or light-industrial applications
- Available surfaced with Formica®, Nevamar®, Pionite®, and Wilsonart® laminate
- Available as an environmentally friendly EQcountertop
- Not available surfaced with solid color laminates

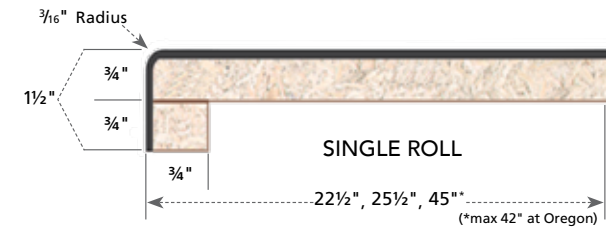
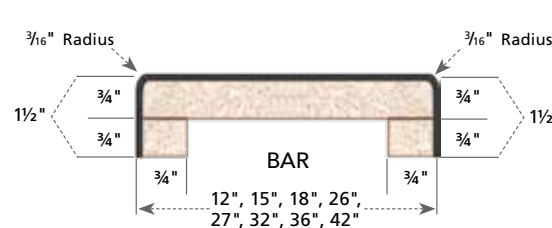
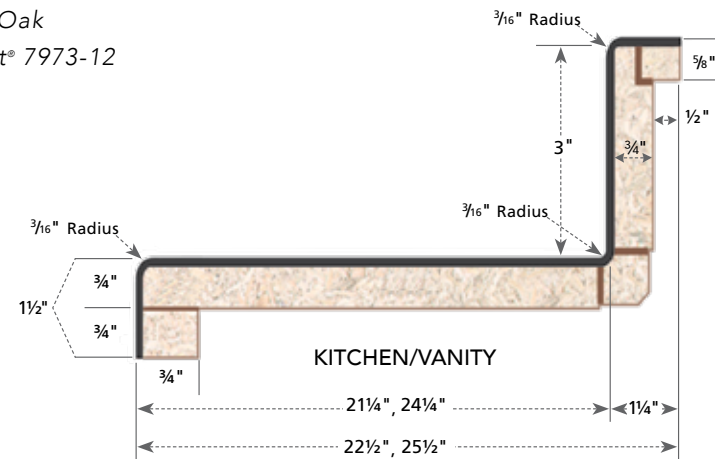

VTDimensions.com | 1-888-287-8356
1000 Industrial Park | P.O. Box 490 | Holstein, IA 51025

©2019 VT Industries, Inc. All rights reserved.
NPMB 0119



All measurements in inches. Drawings not to scale.