

Optima *Waterfall Edge*

Optima creates a classic, seamless waterfall edge that remains one of the most popular choices for a wide variety of applications. The ½" radius on the waterfall edge and backsplash provides a tighter, more contemporary look. By combining the sought-after look of real stone with the no-fuss durability of laminate, VT Dimensions and the Tempo edge take your remodeling dollars further.

Optima Waterfall Edge

Expect More from VT Dimensions

Bring together modern style, intriguing depth, and the seamless edge you want with the beautifully contoured look of VT Dimensions countertops.

Beyond the beauty, you'll have the assurance of knowing VT fabricates the whole countertop from top to bottom—not just the laminate surface—for consistent quality and service. And you get a 1-year warranty you can count on.

One source. Many beautiful looks. Only from VT.

Specifications

- Standard substrate is $\frac{3}{4}$ " industrial-grade particleboard, available in 8', 10', and 12' lengths
- Standard postformed-grade laminate with a thickness of $0.042" + 0.002" - 0.008"$
- Both standard and special styles and sizes are suitable for all residential, commercial, institutional, or light-industrial applications
- Available surfaced with Formica®, Nevamar®, Pionite®, and Wilsonart® laminate
- Available as an environmentally friendly EQcountertop



VTDimensions.com | 1-888-287-8356
1000 Industrial Park | P.O. Box 490 | Holstein, IA 51025

©2015 VT Industries, Inc. All rights reserved.
NPTE-IA 0615



Edge: *Optima*

Laminate: *Bianco Romano*

Wilsonart® 1872-35

Iowa

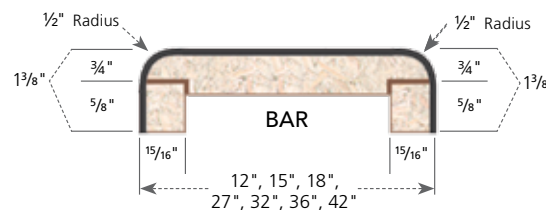
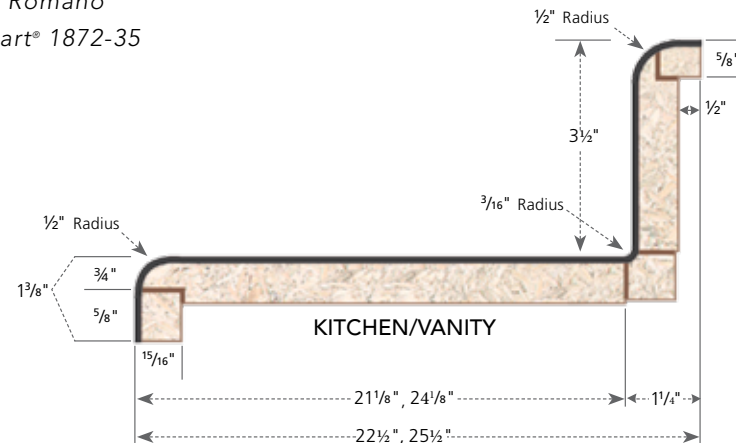

All measurements in inches. Drawings not to scale.